

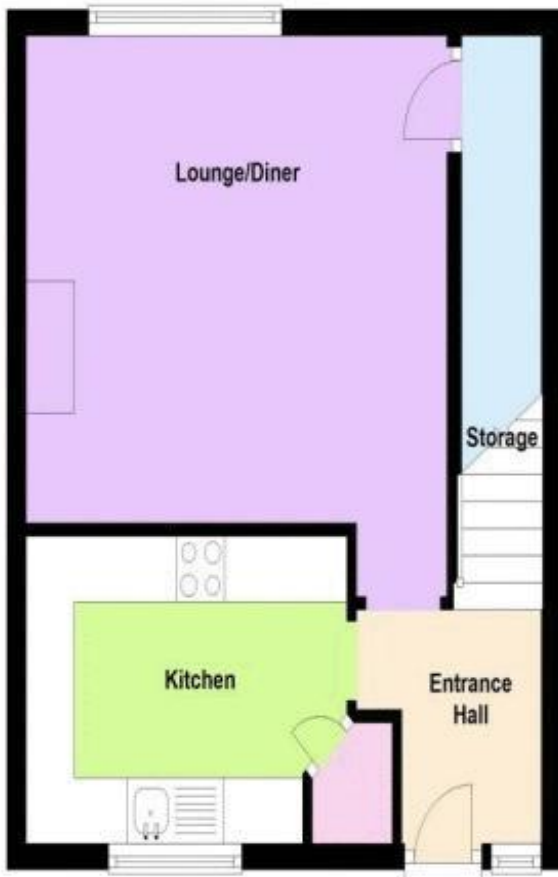

Ground Floor
Approx. 33.1 sq. metres



First Floor
Approx. 33.0 sq. metres



Total area: approx. 66.1 sq. metres

Wainwright Estates

10 The Precinct, London Road
Waterlooville, Hampshire PO7 7DT

Tel: 02392 264500

Email: sales@wainwrightestates.co.uk
www.wainwrightestates.co.uk

8 Rockbourn Close

Havant PO9 4BE

Price: £250,000

DESCRIPTION

Tucked away in a quiet cul-de-sac you will find this 3 bedroom home in Leigh Park. Upon entering the property your eyes will be drawn to the modern fitted kitchen, where one will be able to cook up a storm whilst friends and family relax in the generous sized lounge which overlooks the south facing rear garden. Upstairs you will find 3 well proportioned bedrooms for the growing family and a bathroom with separate WC. Outside there is a south facing rear garden and side pedestrian access. The property offers neutral tones and décor throughout and has the additional benefits of gas central heating, double glazing and is being offered with no forward chain.

ACCOMMODATION

ENTRANCE HALL

KITCHEN 11' 4" x 7' 6" (3.45m x 2.28m)

LOUNGE 14' 6" x 12' 2" (4.42m x 3.71m)

BEDROOM 1 13' 1" x 11' 1" (3.98m x 3.38m)

BEDROOM 2 11' 6" x 6' 8" (3.50m x 2.03m)

BEDROOM 3 9' 4" x 7' 4" (2.84m x 2.23m)



BATHROOM

SEPARATE WC

REAR GARDEN

OFFICE

